

KAPPA-7 / 15 / 18 12-Volt

12-Volt DC Powered Diaphragm Pump

KAPPA Series 12-Volt Diaphragm Pumps are excellent for various pest control, agricultural, lawn care & injection spraying applications.

For spraying applications not listed, please consult UDOR U.S.A.



SPECIFICATIONS

Maximum Flow	KAPPA-7/12-Volt	1.9 GPM
	KAPPA-15/12-Volt	3.2 GPM
	KAPPA-18/12-Volt	4.2 GPM
Maximum Pressure	KAPPA-7/12-Volt	200 PSI
	KAPPA-15/12-Volt	70 PSI
	KAPPA-18/12-Volt	70 PSI
Dimensions	L-14" x W-7" x H-7"	
Weight	22 lbs.	
Liquid Handling Parts	Anodized Aluminum, Glass-filled Nylon & Stainless Steel.	
Diaphragm Material	Standard	DESMOPAN
	Optional	BUNA-N

PERFORMANCE - KAPPA-7 / 12-Volt									
PSI		0	50	75	100	125	150	175	200
GPM		1.9	1.8	1.7	1.7	1.6	1.5	1.4	1.3
AMPS		11.0	13.5	16.0	17.5	19.0	20.5	22.0	24.0
PERFORMANCE - KAPPA-15 / 12-Volt									
PSI		0	10	20	30	40	50	60	70
GPM		3.2	3.2	3.2	3.1	3.1	3.1	3.1	3.1
AMPS		21.0	22.0	23.0	24.5	25.5	27.0	28.0	30.0
PERFORMANCE - KAPPA-18 / 12-Volt									
PSI		0	10	20	30	40	50	60	70
GPM		4.2	4.2	4.1	4.1	4.1	4.0	4.0	3.9
AMPS		22.0	23.0	24.0	25.5	26.5	28.0	29.5	31.0
TEST CONDITIONS 5' of 3/4" suction hose with 3' lift. (3' of 3/4" suction hose with FLOODED SUCTION for KAPPA-7.) POWER SOURCE 12-Volt deep cycle marine battery. NOTE Amperage draw will decrease by 2-4 amps after a 2-4 hour break-in period. KAPPA-7/12-Volt MUST HAVE A FLOODED SUCTION.									

UDOR U.S.A., INC.

500 Apollo Drive
 Lino Lakes, MN 55014
 TEL. (651) 785-0666
 FAX. (800) 732-2670
 www.udorusa.com

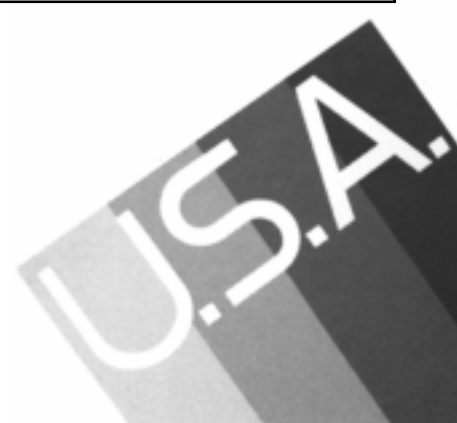

KAPPA-7, KAPPA-15 & KAPPA-18/12-Volt Exploded View Diagram and Parts List

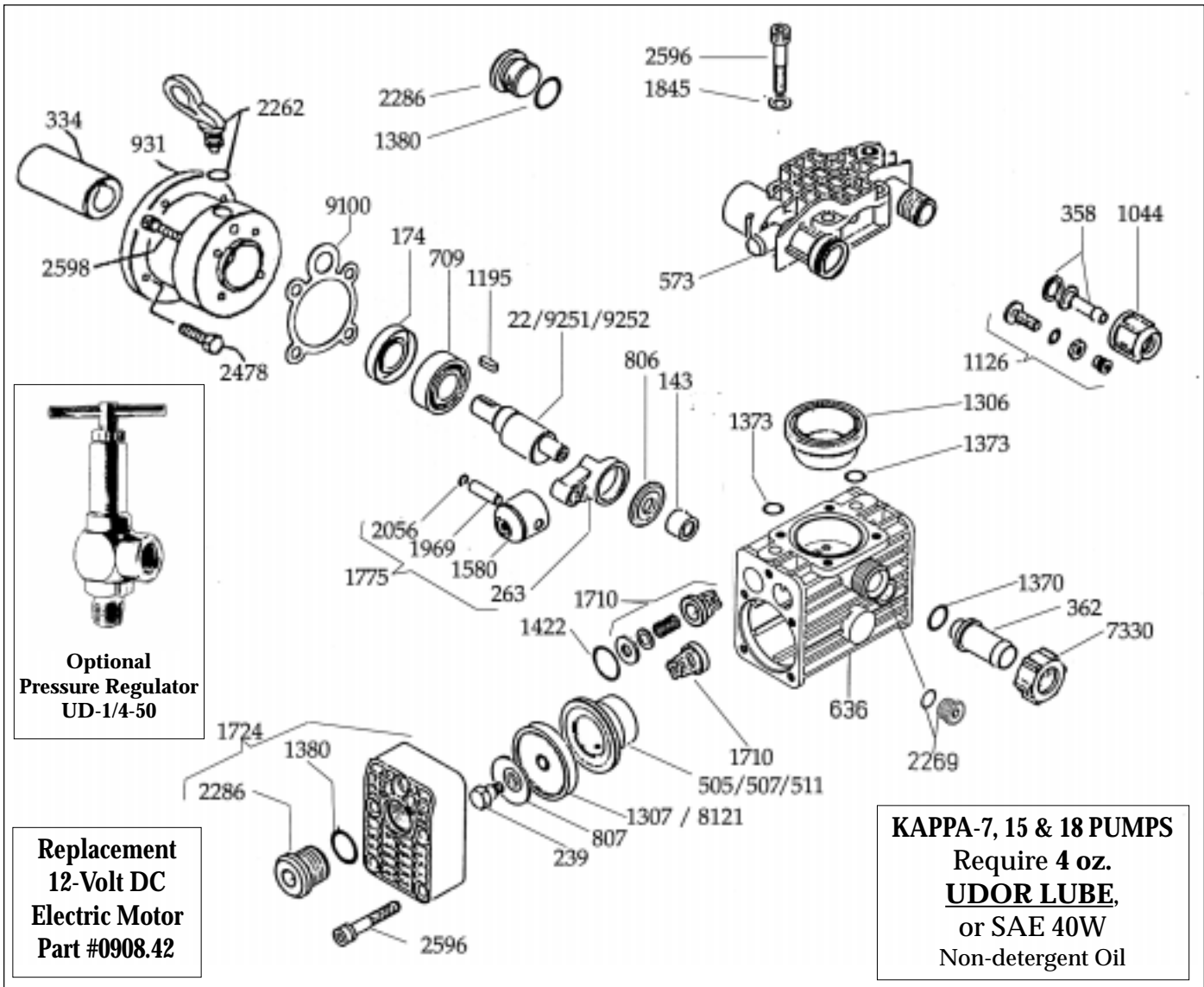

Ref. #	Part #	Qty.	Description	Ref. #	Part #	Qty.	Description
22	0002.75	1	Crankshaft - KAPPA-15	1370	1101.06	1	O-Ring
143	0006.13	1	Bearing	*1373	1101.11	2	O-Ring
174	0007.37	1	Seal	1380	1101.25	3	O-Ring
239	0102.02	2	Diaphragm Bolt	1422	1101.78	4	O-Ring
263	0103.07	2	Connecting Rod	1580	1205.27	2	Piston
334	0113.18	1	Shaft Coupler	1710	6006.11	4	Valve Assembly
358	0202.19	1	1/2" Hose Barb	1724	6017.14	2	Pump Head
362	0202.27	1	Suction Hose Barb	1775	6015.31	2	Piston Rod Assembly
505	0206.33	2	Piston Sleeve - KAPPA-15	1845	1403.10	8	Washer
507	0206.35	2	Piston Sleeve - KAPPA-7	1969	1502.11	2	Wrist Pin
511	0002.96	2	Piston Sleeve - KAPPA-18	2056	1506.24	2	Snap Ring
573	0208.47/12V	1	Discharge Manifold	2262	1603.24	1	Oil Plug
636	0209.48	1	Pump Body	2269	1603.69	1	Oil Sight Glass
709	0214.17	1	Bearing	2286	1603.87	3	Plug
806	0301.35	1	Spacer	2478	1804.68	4	Bolt
807	0301.37	2	Diaphragm Washer	2596	1805.23	14	Bolt, M8 x 40
931	0501.92	1	Flange	2598	1805.31	4	Bolt
1044	0604.41	1	Barb Nut	7330	0604.29	1	Barb Nut
1126	0608.16	1	Air Valve Assembly	*8121	0903.49	2	Piston Diaphragm (DESMOPAN)
1195	0801.08	1	Shaft Key	9100	0602.49	1	Gasket
*1306	0903.44	1	Accumulator Diaphragm	9251	0002.80	1	Crankshaft - KAPPA-7
1307	0903.45	2	Piston Diaphragm (BUNA-N)	9252	0002.96	1	Crankshaft - KAPPA-18

* Parts included in Diaphragm Repair Kit, Part # 8700.27.
Also available in BUNA-N, Part # 8700.28